

SECTION III - JURISDICTION

A. Outdoor Space

Outdoor space is assigned to the jurisdiction of the particular officers as shown on the campus and hospital maps, [Exhibits III-A](#) and [III-B](#). Outdoor space not assigned by [Exhibits III-A](#) or [III-B](#) is under the jurisdiction of the Chancellor's Office.

B. Indoor Space

1. General Use Classroom Space

General Use classrooms are assigned to the jurisdiction of the Registrar for the primary purpose of housing regularly scheduled classroom instruction. See Schedule 1, this Section for listing.

2. Other General Use Areas

There are facilities available for general use by reservation which are under the jurisdiction of specific departments. Departmental use has priority over general use. See Schedule 2, this Section for listing.

3. Specific Use Areas

Space assigned to official units of the University for continuous conduct of University functions is not available for other purposes and is under the jurisdiction of the unit head. Typically this space consists of offices and laboratories.

4. Leased Facilities

The department occupying the leased facilities determines which vice chancellor, dean, or director has jurisdiction over the leased area.

C. Equipment

All University equipment is assigned to the care and control of an official unit of the University. Certain equipment is available for general use through service departments; e.g., Audio Visual sound equipment, Graphics and Reproduction Services copiers, Storehouse typewriters.

All University properties are to be used for University related purposes.

D. Services

Services performed by individuals under employment with the University are defined by specific job descriptions and are under the jurisdiction of the specified supervisor and unit head. Certain departments and individuals perform specialized support services for a general group on a request basis. These fall into three categories:

1. Department Services

Individual or unit organized to provide services to a specific department; e.g., a scientific illustrator whose work is charged to projects within a given department. The unit head has jurisdiction on services performed.

2. Regional Services

Individual or unit organized to provide services to a group of related departments; e.g., Office of Learning Resources in the School of Medicine, Marine Science Development and Outfitting Shop at SIO. These services may be utilized by other University units on a time available basis. The jurisdiction is in the appropriate Dean/Director's Office.

3. General Services

Units organized to service all units of the University campus; e.g., Mail Services, Telecommunication Services, Storehouse. The appropriate Vice Chancellor in central administration has jurisdiction over general services.

Effective: 04/01/1981

Supersedes:

Review Date: TBD

Issuing Office: Business Office

UCSD POLICY AND PROCEDURE MANUAL
USE OF UNIVERSITY PROPERTIES - III JURISDICTION

SECTION 510-1 PAGE 3

Issuing Office: Business Office

Effective: 4/1/81
Supersedes:

Section III
Exhibit A

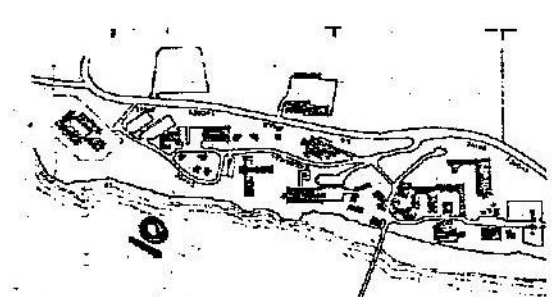
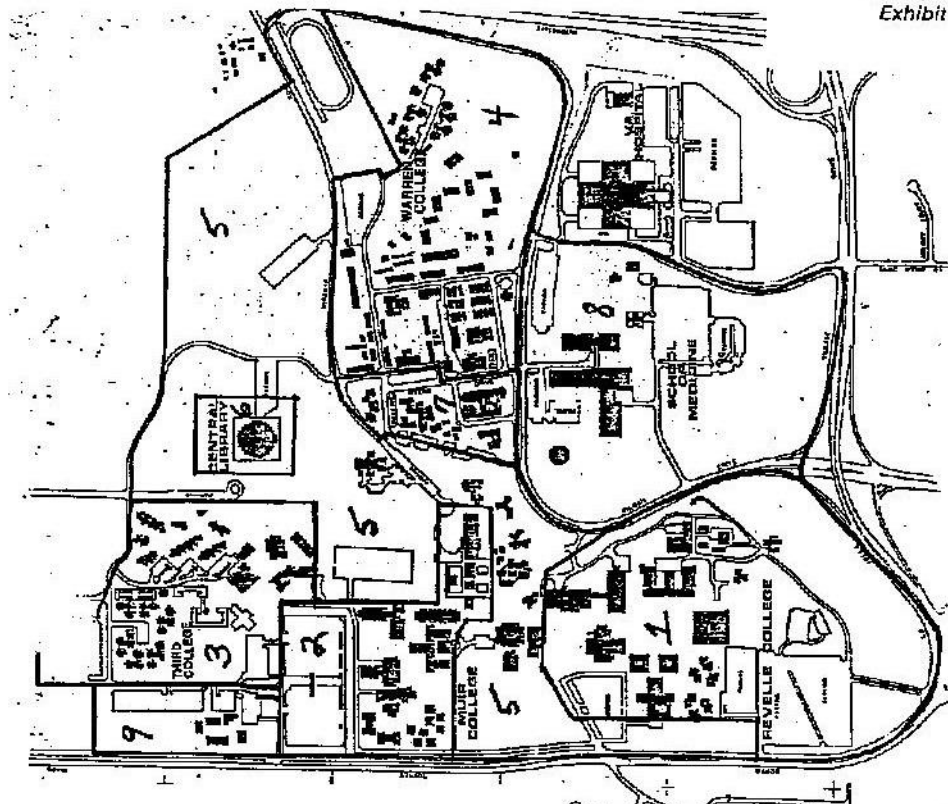

CAMPUS

1. Provost Revelle College
2. Provost Muir College
3. Provost Third College
4. Provost Warren College
5. Vice Chancellor-Student Affairs
6. University Librarian
7. Chancellor's Office
8. Vice Chancellor-Health Sciences
9. Dean, University Extension
10. Director, Scripps Institution of Oceanography

(NOTE: Although not shown, the Pt. Loma facility also is under the jurisdiction of the Director-S10)

Undesignated space is under the jurisdiction of the Chancellor's Office.

Effective: 04/01/1981

Supersedes:

Review Date: TBD

Issuing Office: Business Office

UCSD POLICY AND PROCEDURE MANUAL
USE OF UNIVERSITY PROPERTIES - III. JURISDICTION

SECTION 510-1 PAGE 4

Issuing Office: Business Office

Effective: 4/1/81
Supersedes:

Section III
Exhibit B

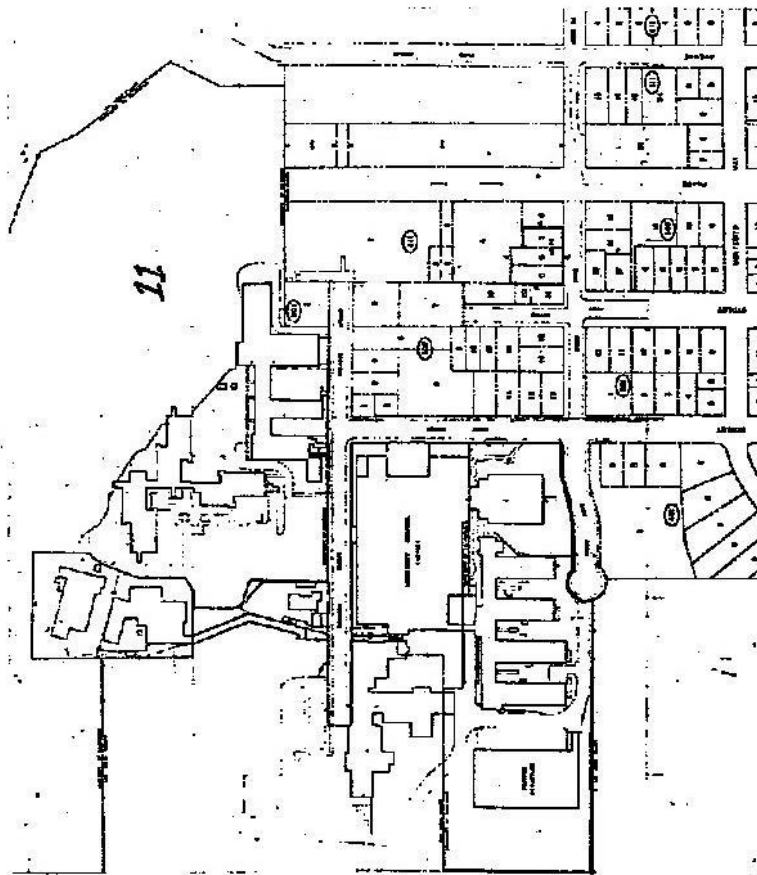

LEGEND:

- 11. The jurisdiction of the University of California, San Diego Medical Center is dependent upon the administration of the facility; i.e., University Hospital is the responsibility of the Director, Hospital & Clinics, while the Clinical Teaching Facility is the responsibility of the Vice Chancellor-Health Sciences.

HOSPITAL